

Caratteristiche tecniche	1 x E27 LED
Tensione di funzionamento	220 / 240 V AC 50Hz

Class II. Apparecchio nel quale la protezione contro la scossa elettrica non si basa unicamente sull'isolamento principale ma anche sulle misure supplementari di sicurezza costituite dal doppio isolamento o dall'isolamento rinforzato.	Indice di protezione IP 20.
Protezione contro l'ingresso di corpi solidi di Ø 12 mm. Nessuna protezione contro la pioggia. Marcatura non prevista sull'apparecchio.	ATTENZIONE L'apparecchio non deve essere smaltito come rifiuto urbano. Deve essere soggetto a raccolta separata per evitare danni all'ambiente. Nel rispetto della Direttiva 2012/19/UE e delle Leggi nazionali adottate per lo smaltimento del prodotto a fine vita, il marchio rispetto al quale sopra è sanzionato dalla Legge. Si prega di informarsi in merito al sistema locale di raccolta differenziata per i prodotti elettrici ed elettronici.

Le parti che conducono corrente non devono entrare in contatto con l'umidità. Le superfici quali paralumi, vetri, riflettori e coperture possono essere pulite con un panno morbido senza detersivo. Proteggere la lampada dall'umidità durante l'uso.	IP20
Protezione level IP 20. Protection is effective against contact with solid bodies of Ø ≥ 12 mm. No protection is provided against rain. No indications are provided on the luminaire.	ATTENTION The product cannot be disposed as unsorted municipal waste. It must be collected separately to prevent negative environmental impacts. In accordance with the procedures of Directive 2012/19/UE and relevant national laws and regulations adopted pursuant to this Directive on the disposal of waste at the end of the life cycle of the product, any violation is sanctioned by law. Please inform yourself about the local separate collection system for electrical and electronic products.

Operating voltage	1 x E27 LED
Technical characteristics	Power

Class II. A luminaire in which protection against electric shock and/or replacing the bulb/ Led.	IP20
Before doing anything, always remove the lamp plug from its socket or turn off the lamp supply circuit, and leave the bulb to cool. When fitting hanging lamps or fixtures always use qualified personnel.	ATTENTION The product cannot be disposed as unsorted municipal waste. It must be collected separately to prevent negative environmental impacts. In accordance with the procedures of Directive 2012/19/UE and relevant national laws and regulations adopted pursuant to this Directive on the disposal of waste at the end of the life cycle of the product, any violation is sanctioned by law. Please inform yourself about the local separate collection system for electrical and electronic products.

Rotaliana srl
via Trento 115 - 117
38017 Mezzolombardo
Trento, Italia

T. +39 0461 602376
info@rotaliana.it
rotaliana.it

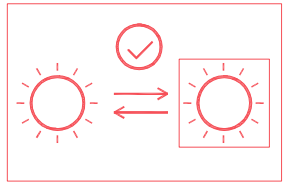

IT- Sorgente luminosa sostituibile dall'utente.

EN- Replaceable light source by an end-user.

FR- Source de lumière remplaçable par un usager final.

DE- Durch einen Endbenutzer austauschbare Lichtquelle.

Drink design: Dante Donegani & Giovanni Lauda

Made in Italy

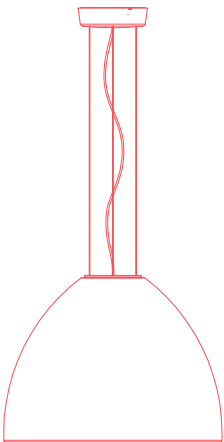

Rotaliana

Drink	cod: H3
Light Source	1 x E27 LED

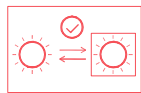

Technische daten:

Leistung	1 x E27 LED
Betriebsspannung	220 / 240 V AC 50Hz

Austausch, Ein- und Ausbau sowie Bedienung der Lampe/Led.	Stromführende Teile dürfen nicht berührt werden. Flächen wie Lampenschirme, Glas, Reflektoren und Abdeckungen können mit einem weichen Tuch ohne Reinigungsmittel gesäubert werden. Die Lampe gegen Feuchtigkeit schützen.
Netzstecker ziehen oder die Lampe vom Stromkreis entfernen. Bei Einrichtung von Vorjahren Berühren stets den allein auf die Hauptisolierung, Schutz gegen Stromschläge nicht der Lampe/Led.	IP20 das Eindringen fester Körper Ø12 mm. Kein Schutz gegen Regenwasser.
Installation, entretien de l'appareil et/ou remplacement de l'ampoule/ Led. Avant toute opération, débrancher la prise de courant ou couper l'alimentation générale de la distribution d'électricité. L'installation des suspensions/appliques doit être effectuée par personnel spécialisé.	IP20 Index de protection IP 20. Protection contre l'entrée de corps solides de Ø ≥ 12 mm. Il n'y a aucune protection contre la pluie. Marquage non prévu sur l'appareil.
Before doing anything, always remove the lamp plug from its socket or turn off the lamp supply circuit, and leave the bulb to cool. When fitting hanging lamps or fixtures always use qualified personnel.	ATTENTION L'appareil ne doit pas être éliminé comme simple déchet urbain mais conformément à la collecte sélective pour garantir la protection de l'environnement. Conformément à la Directive 2012/19/UE et aux dispositions légales qui la transposent pour ce qui touche à l'élimination du produit au terme de sa durée de vie, les contrevenants aux dispositions en vigueur sont passibles des sanctions prévues par la loi. Veuillez vous informer du système local de séparation des déchets électriques et électroniques.

Caractéristiques techniques:

Tension	1 x E27 LED
Power	1 x E27 LED

1

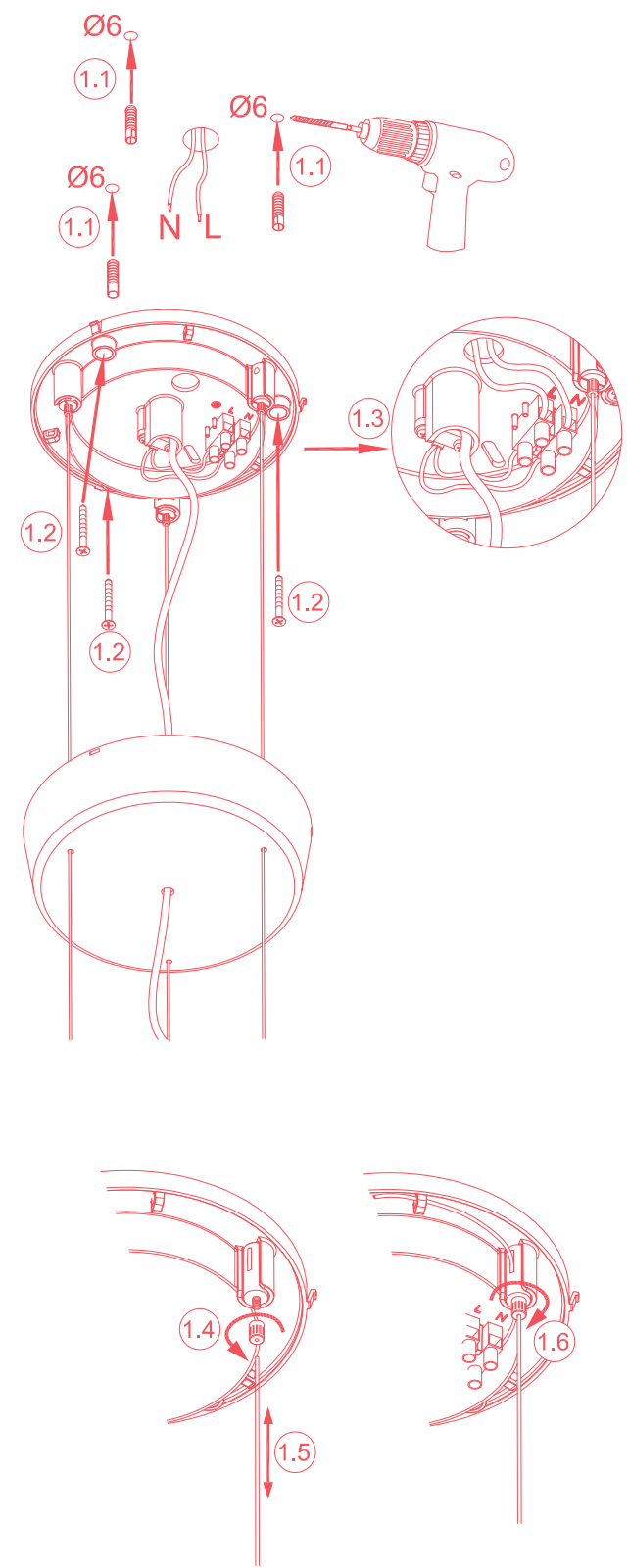

2

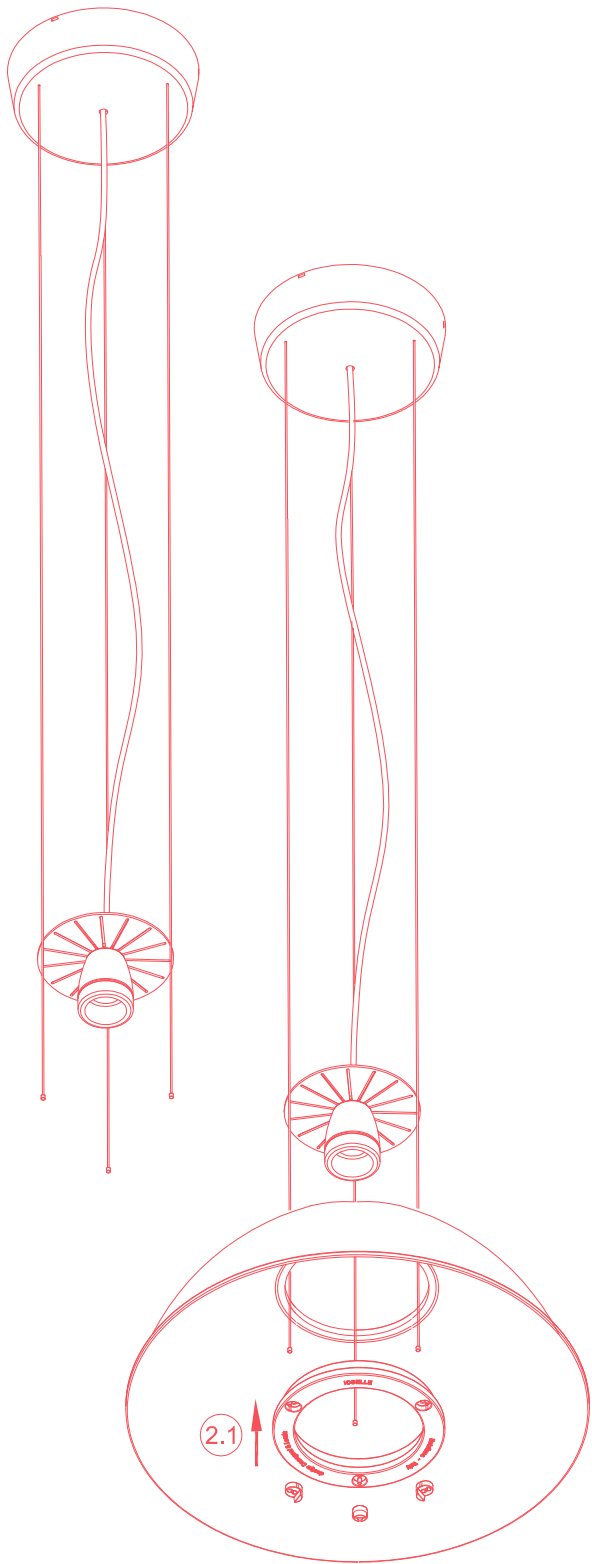

3

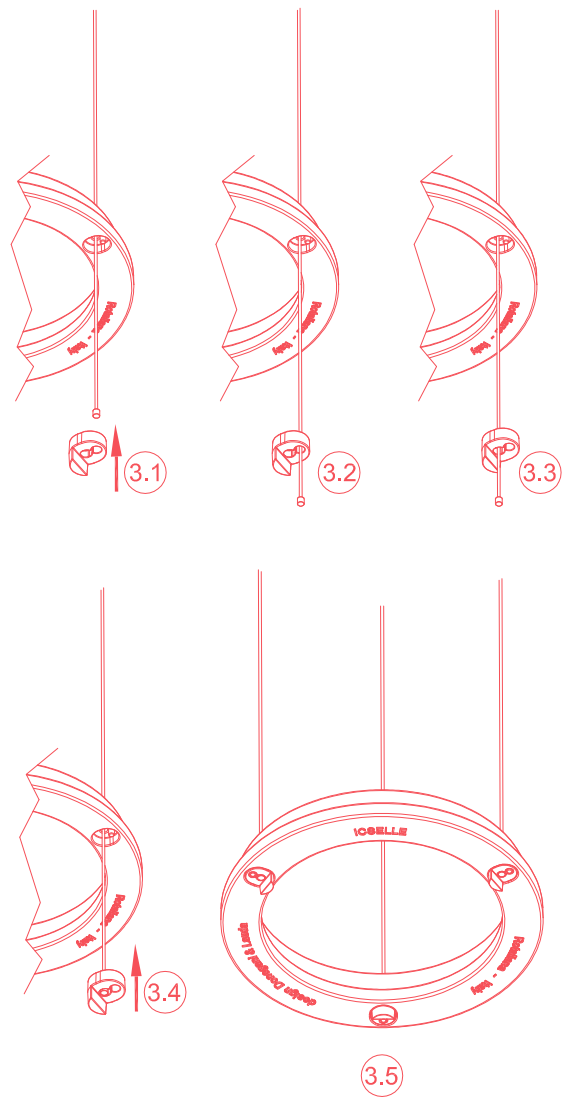

4

